

ADVANTAGES:

- **Two merging solutions**
- **Effective, efficient baggage transfer**
- **Simple, economical design**

OVERVIEW:

Merge conveyors are ideal for integrating baggage flows from two parallel conveyor lines to one combined flow. They can also be used as a loading device when placed adjacent to a pallet loop conveyor, deflecting baggage on to the make-up device.

G&S Airport Conveyor offers two merge conveyor solutions for combining baggage flows:

- Two-Belt Merge Conveyor
- Wide Belt Merge Conveyor

Both solutions utilize a wide-faced, low-friction static deflecting surface that is fixed above the conveyor belt, braced to withstand normal operating forces, yet easy to remove in case of baggage jams. Baggage flow is gently guided across the conveying surfaces at an angle typically no greater than 15° from centreline.

TWO-BELT MERGE CONVEYOR

The two-belt merge is typically used where two independent conveyor lines run parallel to each other, or where a feed conveyor runs adjacent to a pallet loop conveyor, and baggage flow is deflected from one to the other.

This merging solution is typically installed with a minimum distance between frames, preferably 6-inches, and a minimum elevation differential of 4-inches between conveying surfaces. A low-friction spill plate fixed between the two conveyors facilitates baggage transfer over the gap and elevation change.

WIDE-BELT MERGE CONVEYOR

The wide-belt merge conveyor is a stand-alone unit that is constructed as an extra-wide conveying surface for baggage to deflect across. This unit is typically wide enough to accommodate two adjacent in-feed conveyors, with a minimum 6" (152mm) between frames, and a subsequent standard width out-feed conveyor.

Baggage is deflected across a continuously flowing, level transfer surface merging two conveyor baggage flows into one. Baggage jams are minimized as the dead space introduced by spill plates is eliminated, resulting in an efficient, effective baggage merging solution.

DEFLECTOR

- Reinforced, 12-gauge mild steel design
- Adjustable, removable design
- Optional, low friction, UHMWPE deflector surface.

This simple, yet effective deflector design is available in standard heights and can be manufactured to accommodate site conditions. Complimented with rigid supports that are fully adjustable, this device can be fine-tuned to optimize regular operations.



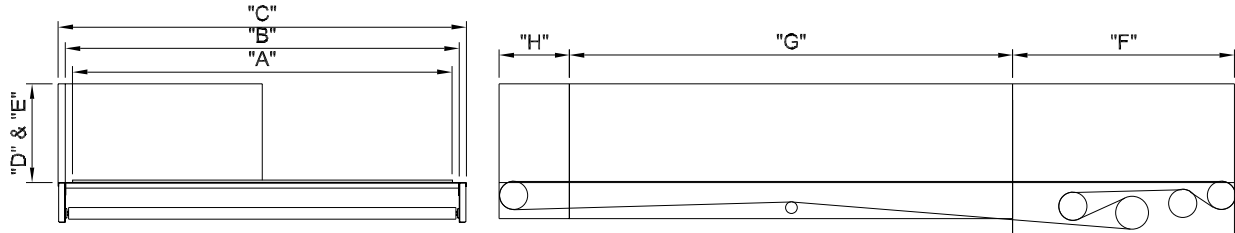

WIDE-BELT MERGE CONVEYOR SPECIFICATIONS	
Description	G&S Standards
Dimensions	
Belt Width ("A") *	72" (1829mm), 78" (1981mm), 84" (2134mm), 108" (2743mm)
Between Frame Width ("B")	75" (1905mm), 81" (2057mm), 87" (2210mm), 111" (2819mm)
Overall Width ("C")	78" (1981mm), 84" (2134mm), 90" (2286mm), 114" (2896mm)
Side Guard Height ("D")	9" (229mm), 12" (305mm), 21" (533mm)
Baggage Deflector Height ("E")	9" (229mm), 12" (305mm), 21" (533mm)
Drive Module Length ("F")	3'-11¼" (1200mm)
Standard Module Length ("G")	7'-10½" (2400mm)
Tail Module Length ("H")	1'-3" (381mm)
Rollers	
Drive Roller Dia (lagged)	Ø7? " (194mm)
O/S Drive Roller Dia (lagged)	Ø8½" (216mm)
Take-up Roller Dia	Ø6" (152mm)
Head Roller Dia	Ø6" (152mm)
Tail Roller Dia	Ø6" (152mm)
Specifications	
Speed	As per customer
Load Capacity (Live Load)	40 lbs/ft (59.53 kgs/m) maximum

*Other belt widths can be manufactured to accommodate site conditions



Sortation Solutions – Section 5.6
Merge Conveyor

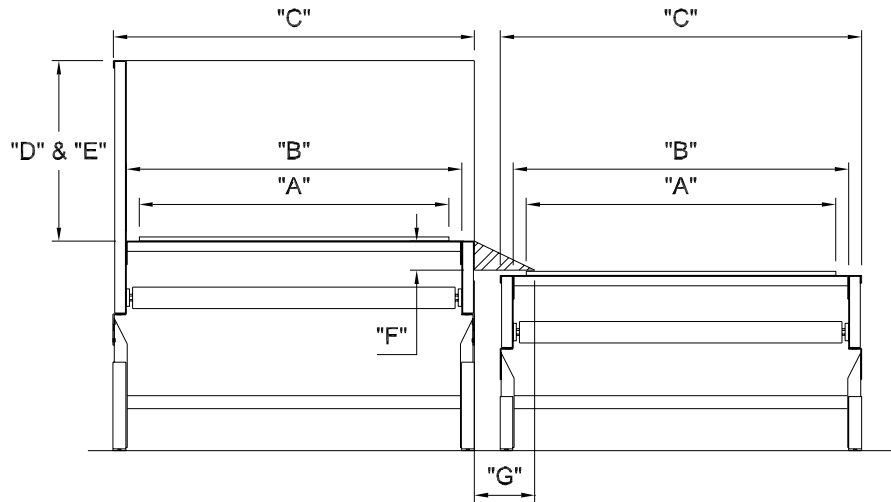

TWO-BELT MERGE CONVEYOR SPECIFICATIONS	
Description	G&S Standards
Dimensions	
Belt Width ("A")	30" (762mm), 33" (838mm), 36" (914mm), 48" (1219mm)
Between Frame Width ("B")	33"(838mm), 36" (914mm), 39" (991mm), 51" (1295mm)
Overall Width ("C")	36" (914mm), 39" (991mm), 42" (1067mm), 54" (1372mm)
Side Guard Height ("D")	9" (229mm), 21" (533mm)
Baggage Deflector Height ("E")	9" (229mm), 21" (533mm)
Center Transition Plate Height ("F")	4" (102mm)
Center Transition Plate Length ("G")	6" (152mm)

Belting Options				
Application	Standard		Optional	
	Make	Model	Make	Model
All	Nitta	BLC-18DKF2	Ammeraal Beltech	EX 10/2 0+00 AS FR
			Habasit	NNT-10ESBU
			Siegling America	E12/2 V1/V1 M-FR Black

Drive Options				
Application	Standard		Optional	
	Make	Model	Make	Model
90 Deg. Reducer	SEW Eurodrive	SA - Hollow Shaft ST - TorqLOC	Morse	
			Dodge	Ti-Gear
Belt Drive			Baldor (motor)	
			Reliance (motor)	
			Dodge (speed reducer)	TXT